

**ELEVABLE DOMO 125RT**

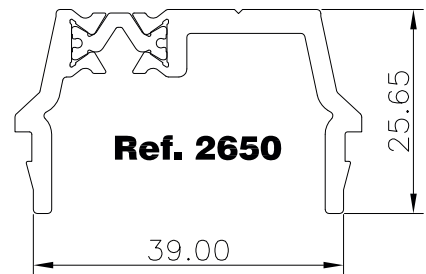

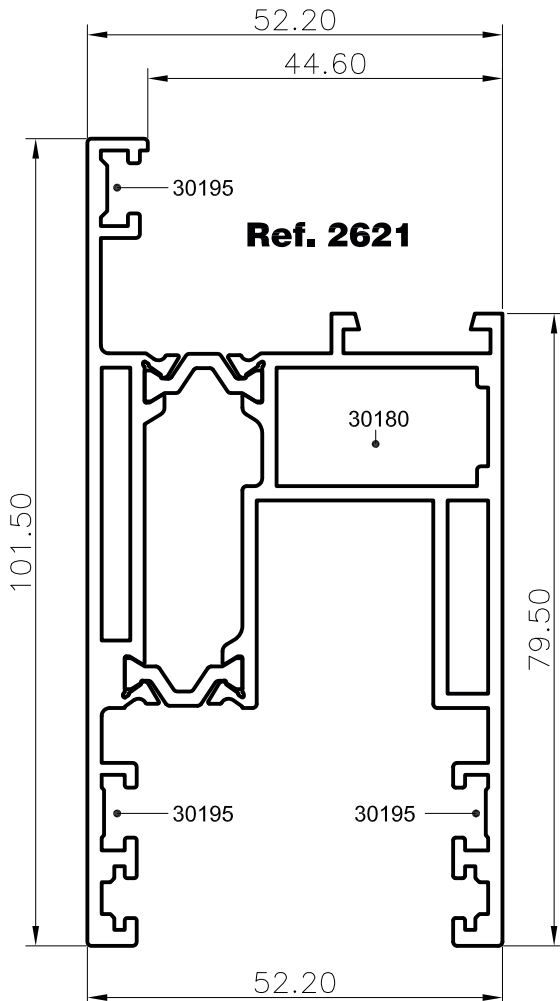

ELEVABLE DOMO 125RT

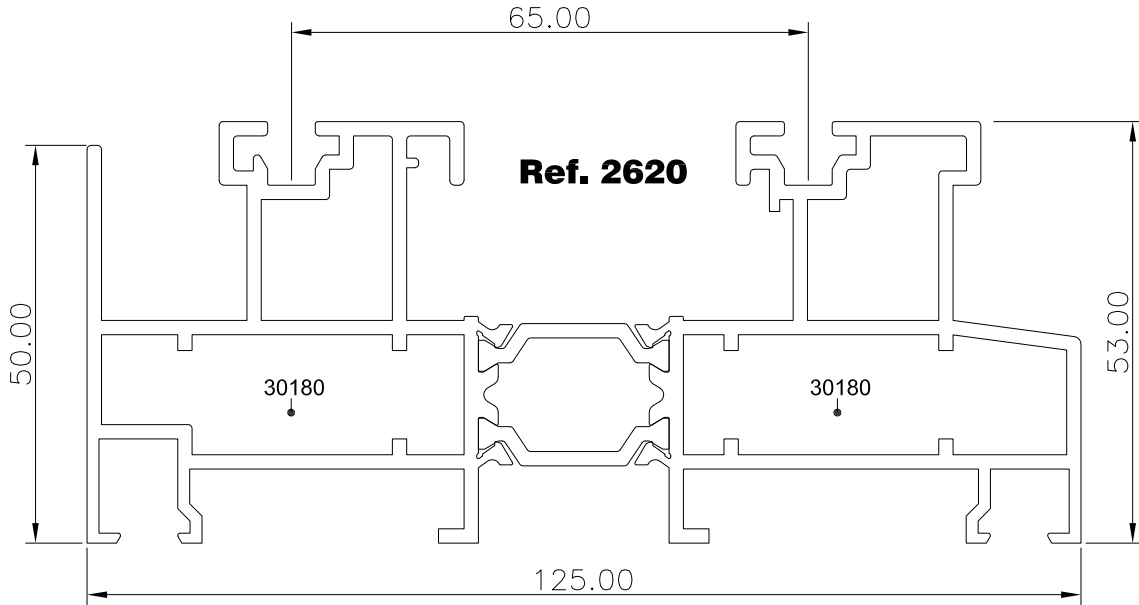
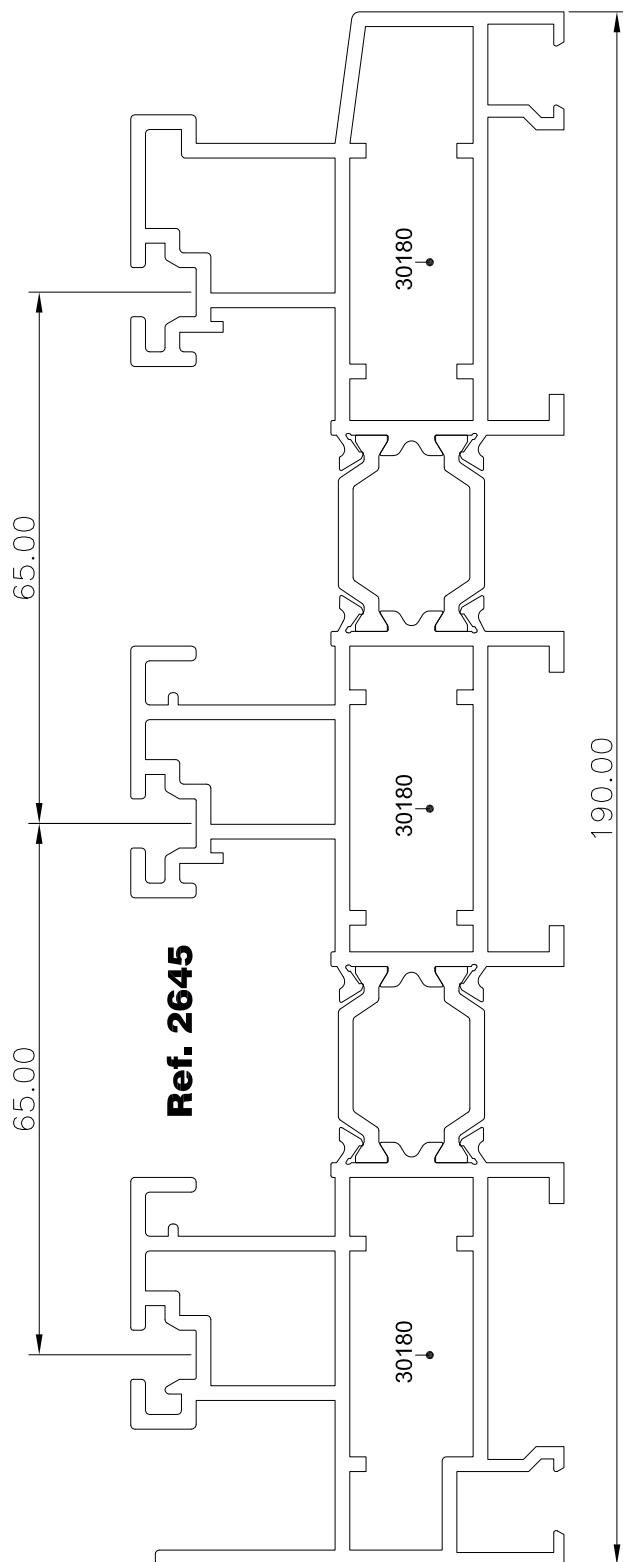

Ctra. Estación, s/n • 36720 GUILLAREI - TUI (Pontevedra)  
Teléfono 986 607 133 • Fax 986 607 134

**ELEVABLE DOMO 125RT**

**Ref. 2640**

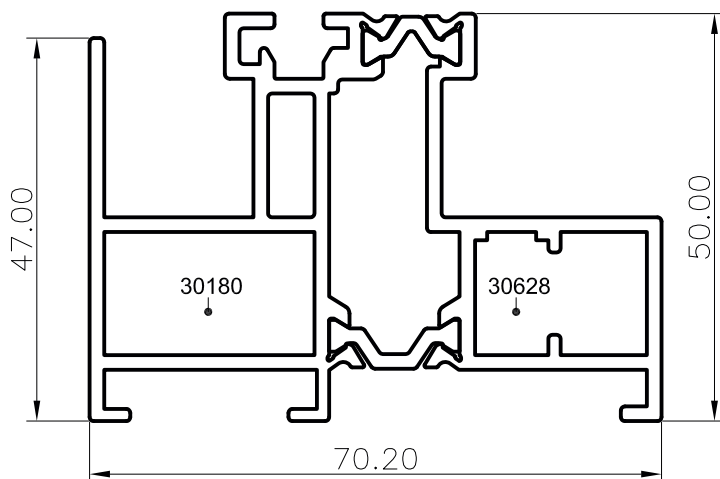

**Ref. 2642**

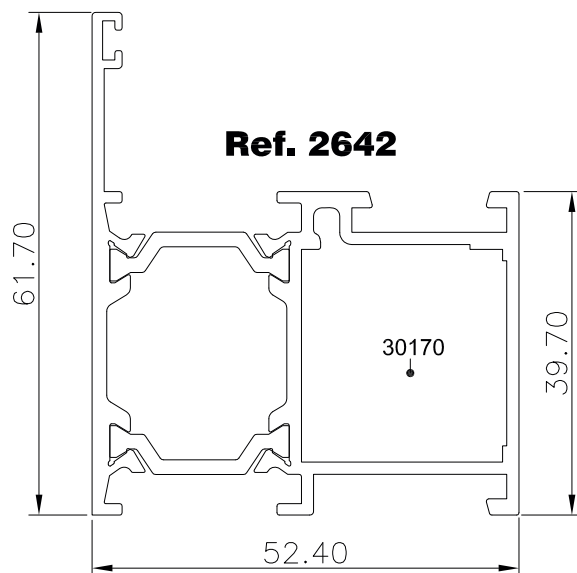

**Ref. 2641**

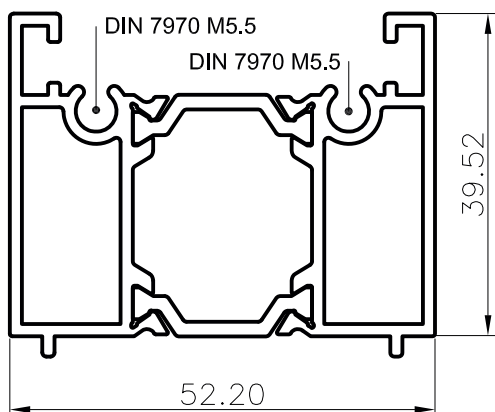

**Ref. 2659**

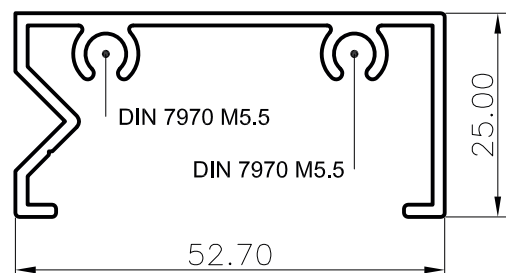

## ELEVABLE DOMO 125RT

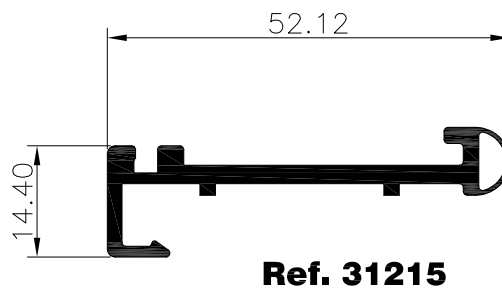
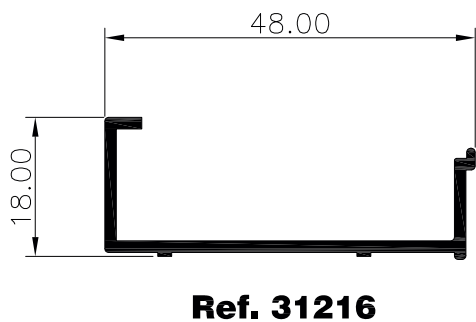
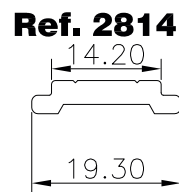
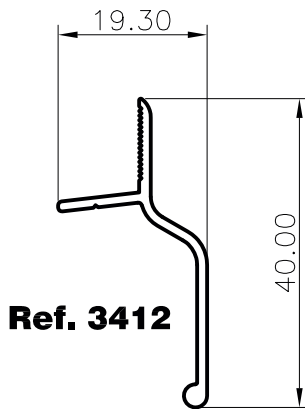
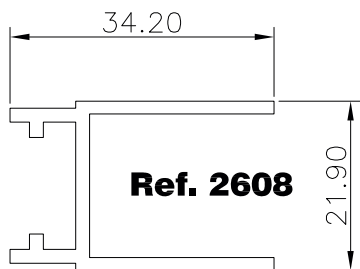
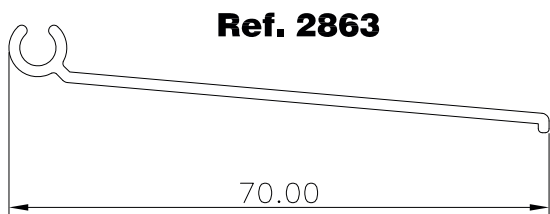
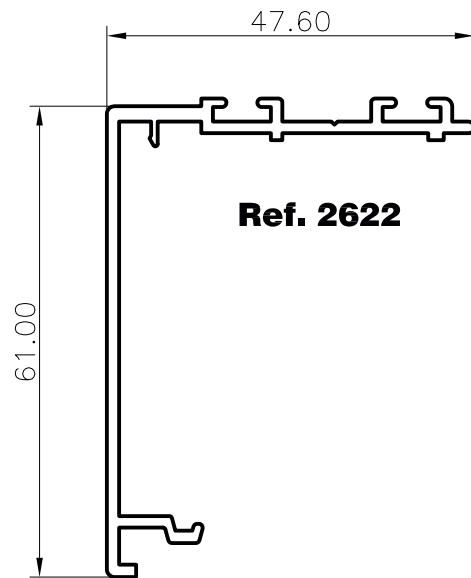
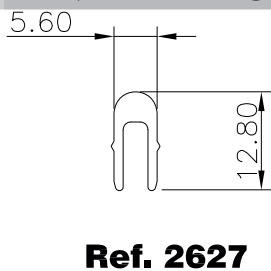
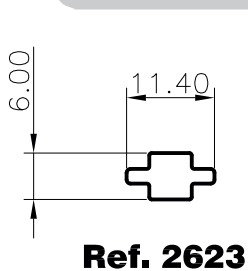

## ELEVABLE DOMO 125RT

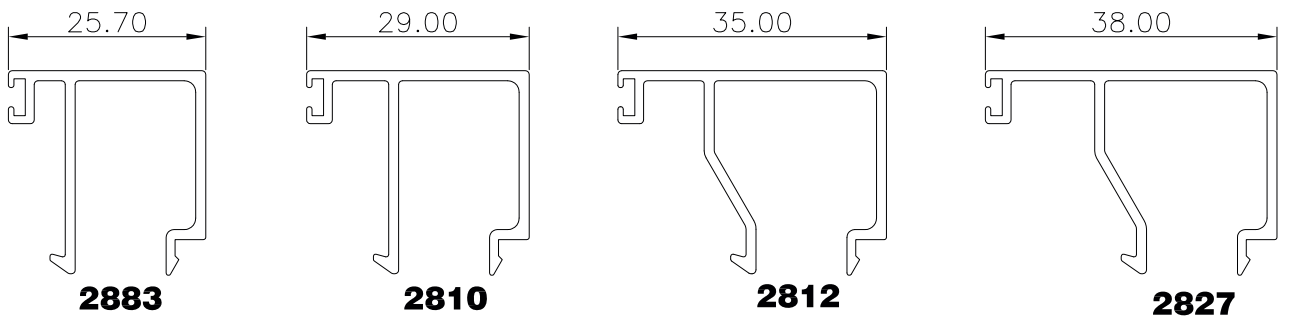
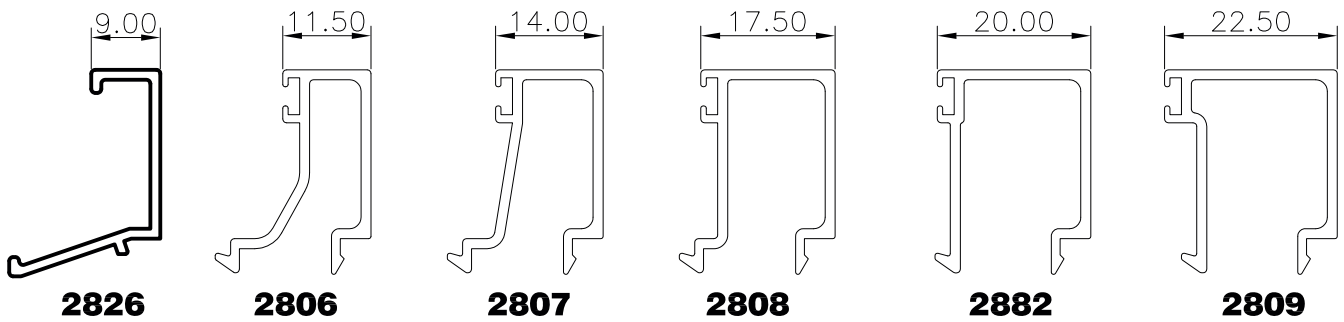
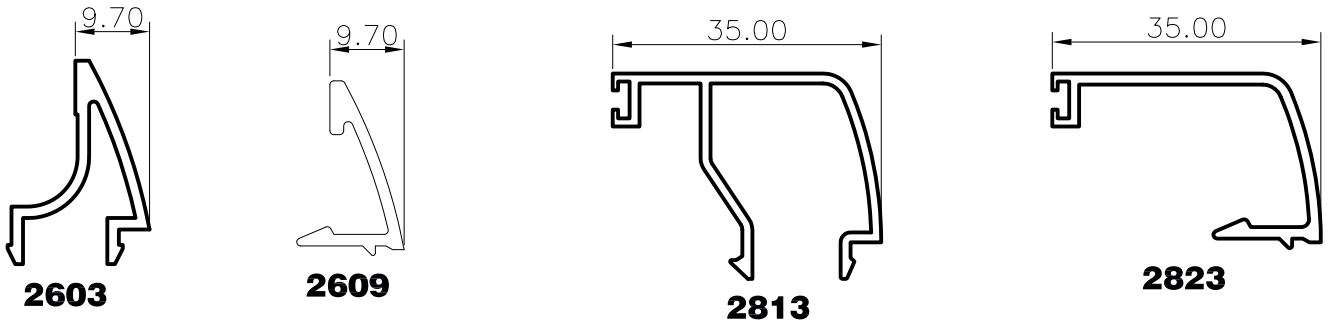
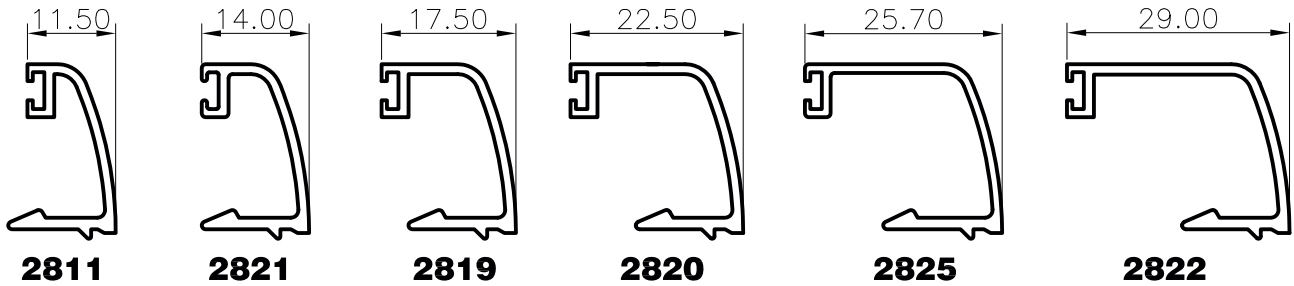
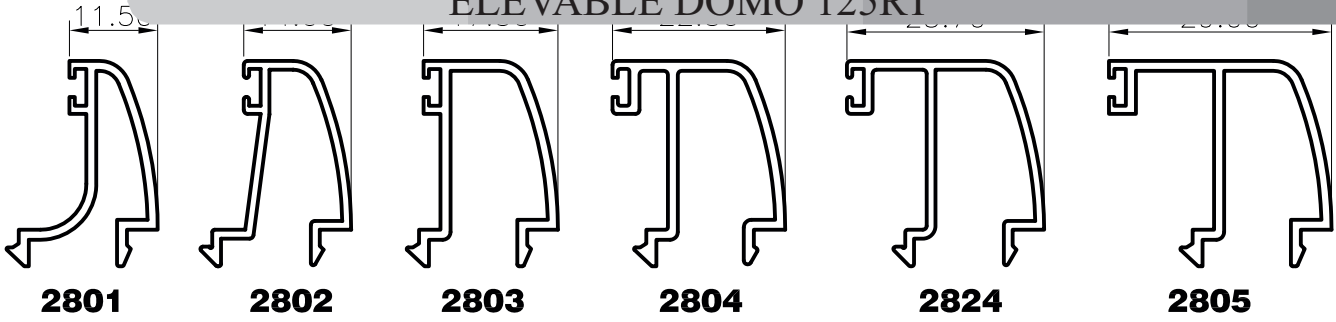

## ELEVABLE DOMO 125RT

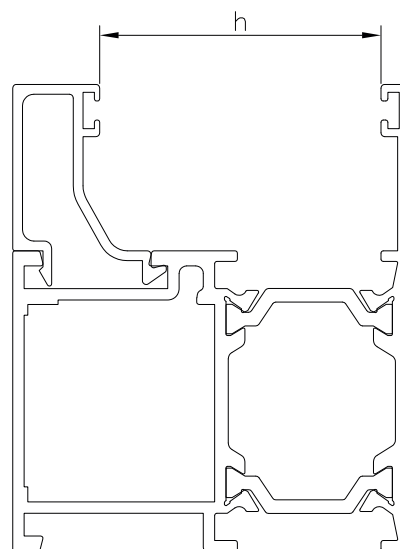
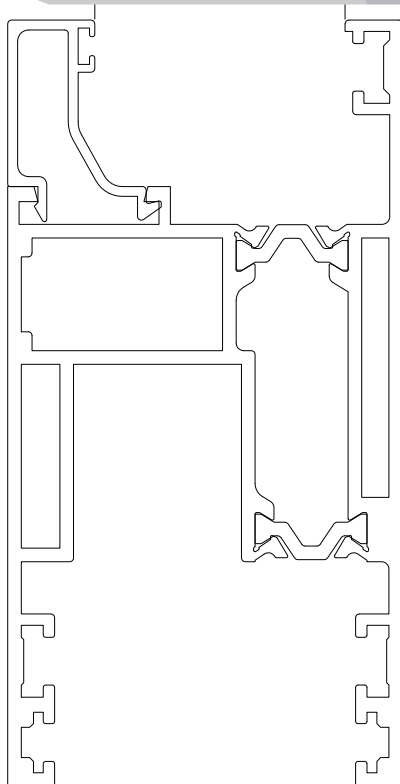

### HUECOS LIBRES PARA ACRISTALAR

Hueco en hoja 2621	
Referencia	Hueco (h)
2826 (9.0mm)	35.50 mm
2806 (11.5mm)	33.00 mm
2807 (14.0mm)	30.50 mm
2808 (17.5mm)	27.00 mm
2882 (20.0mm)	24.50 mm
2809 (22.5mm)	22.00 mm
2883 (25.7mm)	19.00 mm
2810 (29.0mm)	15.50 mm
2812 (35.0mm)	9.50 mm
2827 (38.0mm)	6.50 mm

Hueco en marco 2642	
Referencia	Hueco (h)
2826 (9.0mm)	39.00 mm
2806 (11.5mm)	37.00 mm
2807 (14.0mm)	34.00 mm
2808 (17.5mm)	31.00 mm
2882 (20.0mm)	28.50 mm
2809 (22.5mm)	26.00 mm
2883 (25.7mm)	21.00 mm
2810 (29.0mm)	19.00 mm
2812 (35.0mm)	13.00 mm
2827 (38.0mm)	10.00 mm

## ELEVABLE DOMO 125RT

CREATIVOS

Ventana 2 hojas elevable

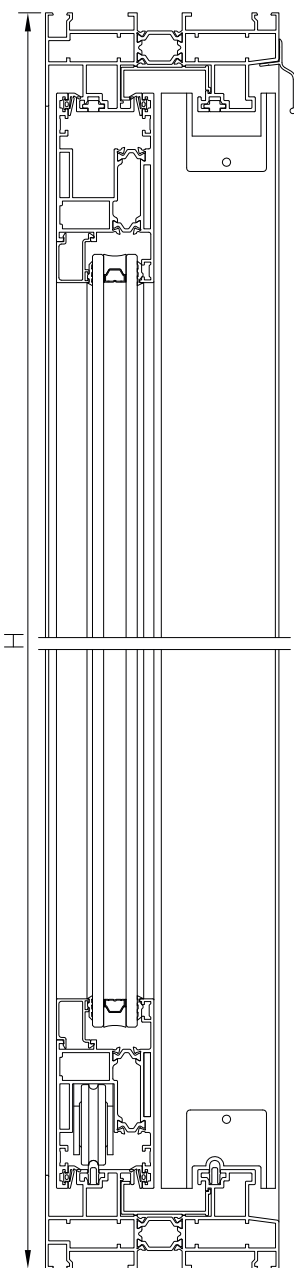
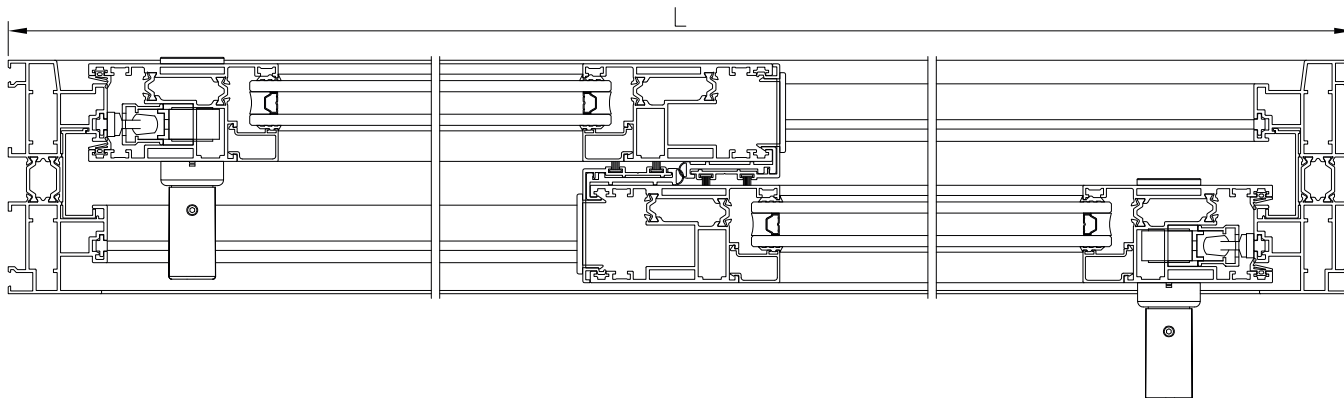

	Ref.	Descripción	Horizontal			Vertical		
			Corte	Cantidad	Medida	Corte	Cantidad	Medida
	2620	Marco perimetral rpt		2	L		2	H
	2621	Hoja perimetral rpt		4	L/2 + 5		4	H - 87
	2622	Cruce de hojas rpt					2	H - 87
	31215	Cruce hojas (Perfil termoplástico)					2	H - 87
	31216	Tapa canal marco (Perfil termoplástico)		2	L		2	H
	2623	Tapa canal marco		2	L		4	H
	2627	Guía de rodadura		2	L			
	3412	Vierteaguas		1	L			
		Junquillo		4	L/2 - 154		4	H-288

Ref.	Descripción	Horizontal		Vertical	
		Cantidad	Medida	Cantidad	Medida
31061	Junta elevable	8	L / 2	4	H
30709	Cepillo 7x7			4	H

Ref.	Descripción	Cantidad
30180	Escuadra ventana	16
30195	Escuadra alineamiento hoja	24
30464	Juego tapas cruce de hojas	2
30122	Cortavientos inferior	1
30126	Cortavientos superior	1
30375	Tapa salida de aguas	L/500+1
	Herraje	Tabla

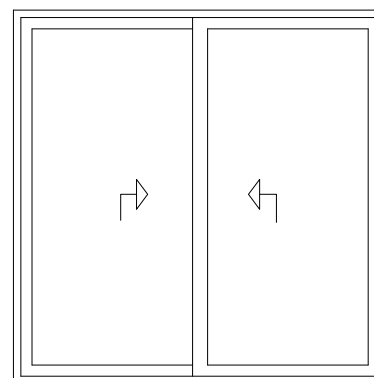



## ELEVABLE DOMO 125RT

Ventana 3 hojas elevables marco tricarril

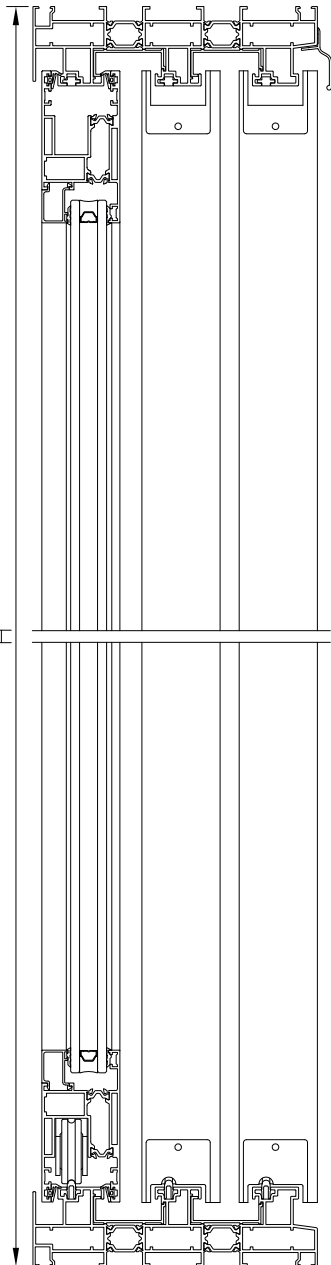
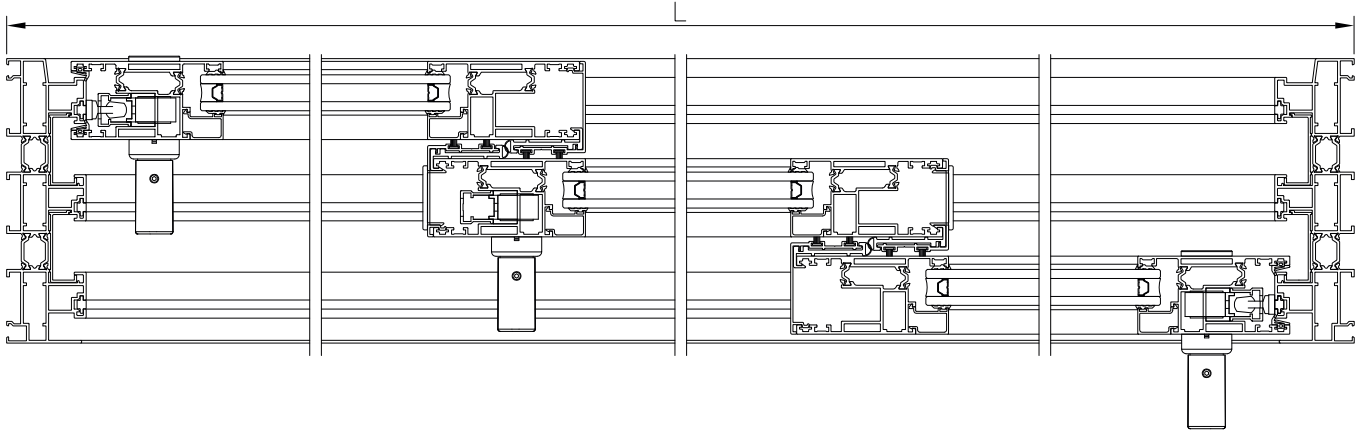

	Ref.	Descripción	Horizontal			Vertical		
			Corte	Cantidad	Medida	Corte	Cantidad	Medida
	2620	Marco perimetral rpt		2	L		2	H
	2621	Hoja perimetral rpt		6	L/3+36		6	H - 87
	2622	Cruce de hojas rpt					4	H - 87
	31215	Cruce hojas (Perfil termoplástico)					4	H - 87
	31216	Tapa canal marco (Perfil termoplástico)		4	L		4	H
	2623	Tapa canal marco		3	L		6	H
	2627	Guia de rodadura		3	L			
	3412	Vierteaguas		1	L			
		Junquillo		6	L/3-122		6	H-288

Ref.	Descripción	Horizontal		Vertical	
		Cantidad	Medida	Cantidad	Medida
31061	Junta elevable	12	L / 3	4	H
30709	Cepillo 7x7			8	H

Ref.	Descripción	Cantidad
30180	Escuadra marco	24
30195	Escuadra alineamiento hoja	24
30464	Juego tapas cruce de hojas	4
30122	Cortavientos inferior	2
30126	cortavientos superior	2
30375	Tapa salida de aguas	L/500+1
	Herraje	Tabla

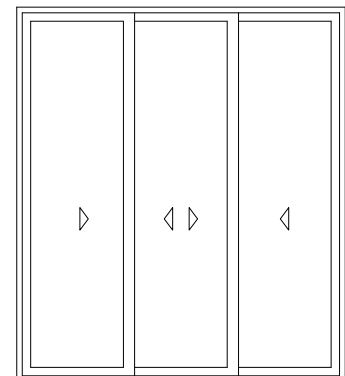







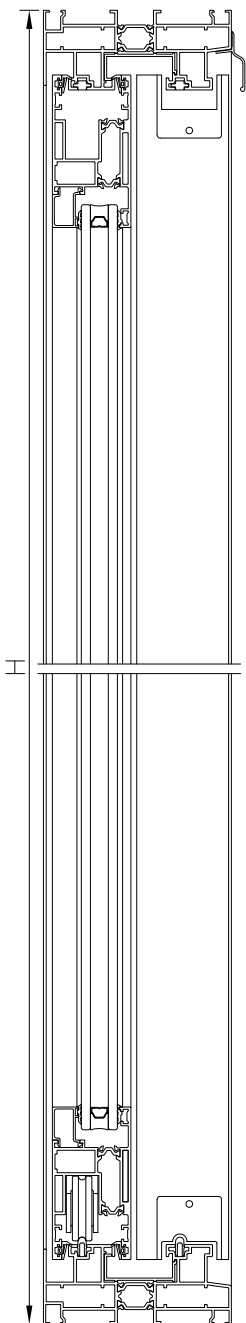
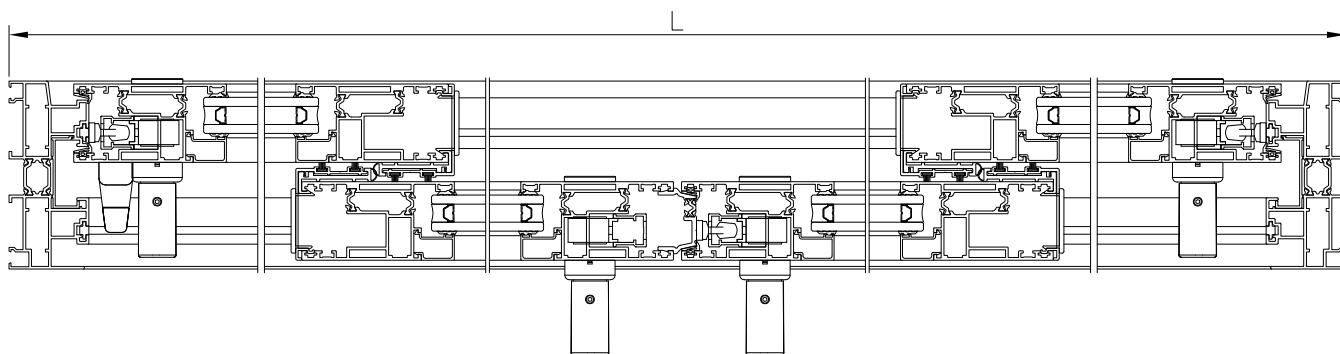



















## ELEVABLE DOMO 125RT

Ventana 4 hojas elevable



	Ref.	Descripción	Horizontal			Vertical		
			Corte	Cantidad	Medida	Corte	Cantidad	Medida
	2620	Marco perimetral rpt		2	L		2	H
	2621	Hoja perimetral rpt		8	L/4 + 26		8	H - 87
	2622	Cruce de hojas rpt					4	H - 87
	2650	Unión 4 hojas					1	H - 87
	31215	Cruce hojas (Perfil termoplástico)					4	H - 87
	31216	Tapa canal marco (Perfil termoplástico)		2	L		2	H
	2623	Tapa canal marco		2	L		4	H
	2627	Guía de rodadura		2	L			
	3412	Vierteaguas		1	L			
		Junquillo		8	L/4 - 133		8	H-288

Ref.	Descripción	Horizontal		Vertical	
		Cantidad	Medida	Cantidad	Medida
31061	Junta elevable	16	L / 4	6	H
30709	Cepillo 7x7			8	H

Ref.	Descripción	Cantidad
30180	Escuadra ventana	24
30195	Escuadra alineamiento hoja	48
30464	Juego tapas cruce de hojas	4
30122	Cortavientos inferior	3
30126	Cortavientos superior	3
30375	Tapa salida de aguas	L/500+1
	Herraje	Tablas

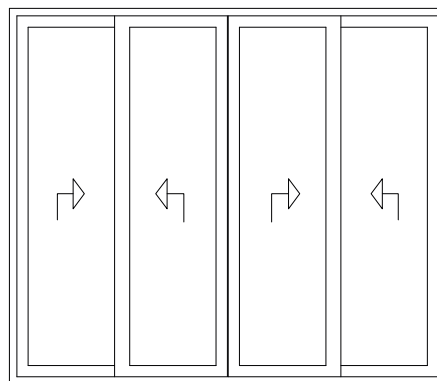



## ELEVABLE DOMO 125RT

Ventana 1 hoja elevable + fijo

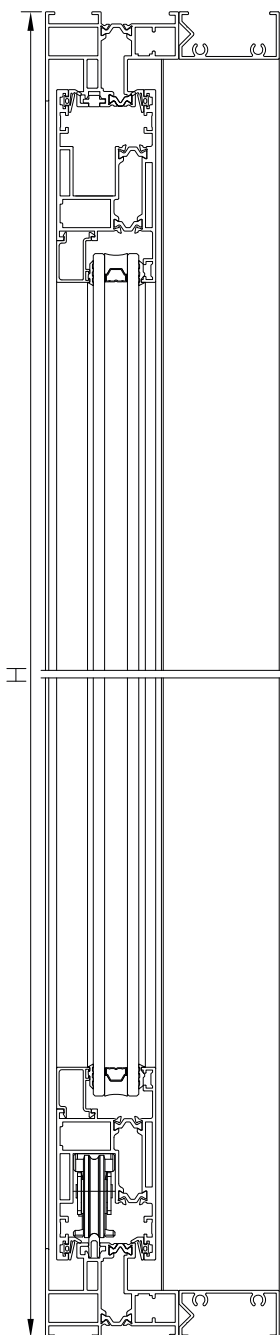
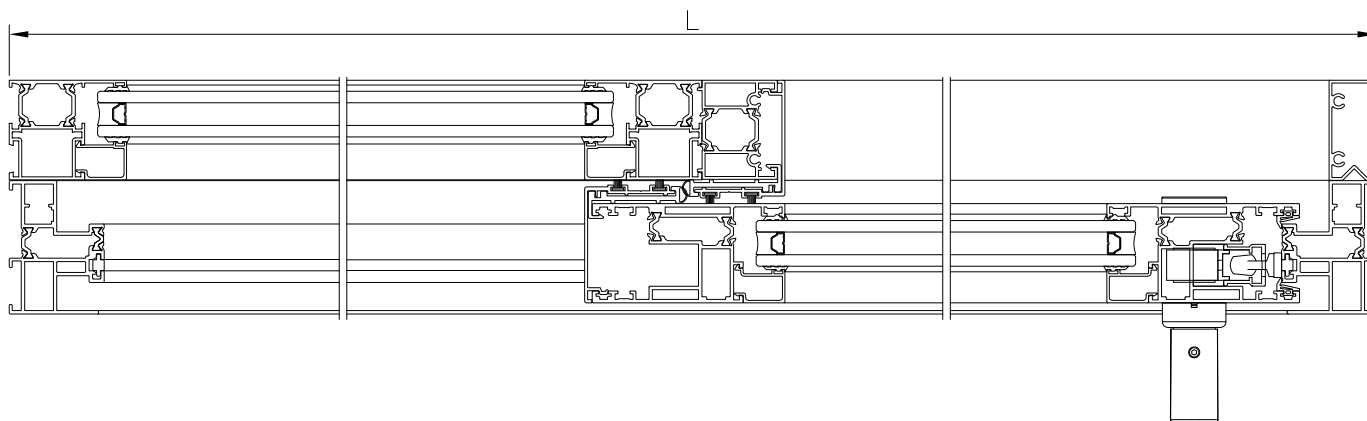

	Ref.	Descripción	Horizontal			Vertical		
			Corte	Cantidad	Medida	Corte	Cantidad	Medida
	2640	Marco perimetral 1 hoja		2	L		2	H
	2621	Hoja perimetral rpt		2	L/2 + 48		2	H - 81
	2641	Acople hoja central					1	H - 50
	2642	Marco fijo		2	L/2 - 31		2	H
	2659	Perfil exterior		2	L/2 + 31		1	H - 50
	2622	Cruce de hojas rpt					1	H - 87
	31215	Cruce hojas (Perfil termoplástico)					1	H - 87
	2623	Tapa canal marco rpt		1	L		2	H
	2627	Guia de rodadura		1	L			
		Junquillo hoja Junquillo fijo		4	L/2 - 111		2	H-285 H-123

Ref.	Descripción	Horizontal		Vertical	
		Cantidad	Medida	Cantidad	Medida
31061	Junta elevable	4	L / 2	2	H
30709	Cepillo 7x7			4	H



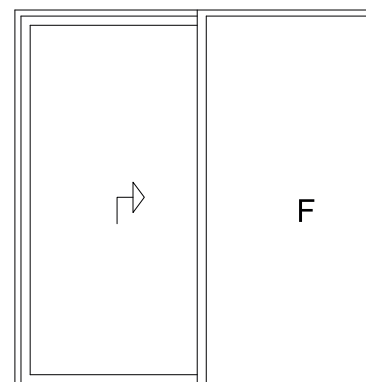





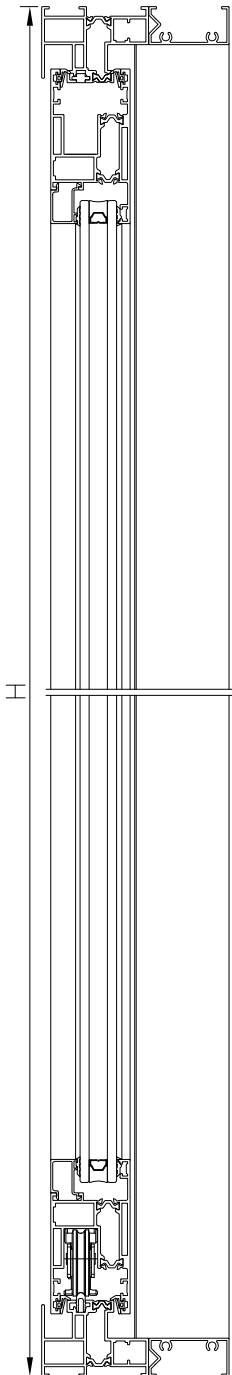
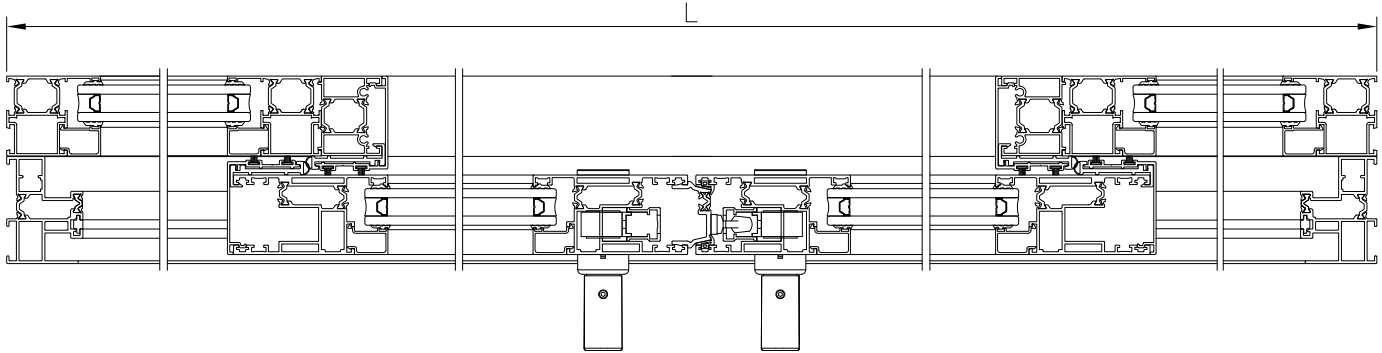

















Ref.	Descripción	Cantidad
30180	Escuadra marco y hoja	8
30170	Escuadra fijo	4
30628	Escuadra exterior marco	4
30195	Escuadra alineamiento hoja	8
30464	Juego tapas cruce de hojas	1
30122	Cortavientos inferior	1
30126	Cortavientos superior	1
30375	Tapa salida de aguas	L/500+1
	Herraje	Tabla



## ELEVABLE DOMO 125RT

Ventana 2 hojas elevables + fijos laterales



	Ref.	Descripción	Horizontal			Vertical		
			Corte	Cantidad	Medida	Corte	Cantidad	Medida
	2640	Marco perimetral 1 hoja		2	L		2	H
	2621	Hoja perimetral rpt		4	L/4 + 67		4	H - 81
	2641	Acople hoja central					2	H - 50
	2642	Marco fijo		4	L/4-12		4	H
	2659	Perfil exterior		2	L/2 + 25			
	2622	Cruce de hojas rpt					2 2	H - 87 H - 50
	31215	Cruce hojas (Perfil termoplástico)					2 2	H - 87 H - 50
	2650	Unión 4 hojas					1	H - 87
	2623	Tapa canal marco rpt		1	L		2	H
	2627	Guía de rodadura		1	L			
		Junquillo hoja Junquillo fijo		8	L/4 - 92		4 4	H-285 H-123

Ref.	Descripción	Horizontal		Vertical	
		Cantidad	Medida	Cantidad	Medida
31061	Junta elevable	8	L / 4	2	H
30709	Cepillo 7x7			8	H

Ref.	Descripción	Cantidad
30180	Escuadra marco y hoja	12
30170	Escuadra fijo	8
30628	Escuadra exterior marco	8
30195	Escuadra alineamiento hoja	16
30464	Juego tapas cruce de hojas	2
30122	Cortavientos inferior	3
30126	Cortavientos superior	3
30375	Tapa salida de aguas	L/500+1
	Herraje	Tabla

